

COUNTY OF LEHIGH, PENNSYLVANIA
COMMISSIONERS BILL 2013-51
SPONSORED BY COMMISSIONER OTT
REQUESTED DATE: OCTOBER 23, 2013
ORDINANCE NO. 2013-

APPROVING THE GRANT OF RIGHT-OF-WAY TO PPL ALONG
BROADWAY ROAD

WHEREAS, the County of Lehigh (the "County") owns property located along Broadway Road, situate in the Township of South Whitehall, County of Lehigh, Pennsylvania; and

WHEREAS, PPL Electric Utilities Corporation ("PPL") is seeking a right-of-way from the County granting PPL the right, privilege and authority to construct, reconstruct, operate and maintain its electric and communication lines consisting of one (1) pole, one (1) pad mounted transformer and underground facilities including wires, cables, fixtures and apparatus upon, across, over, under and along the aforesaid property owned by the County, as more fully described in the Right-of-Way Agreement attached hereto as Exhibit "A"; and

WHEREAS, Section 310(a)(6) of the Home Rule Charter of the County of Lehigh requires ordinance approval for the conveyance of any interest in real estate.

**NOW, THEREFORE, IT IS HEREBY ENACTED AND ORDAINED BY
THE BOARD OF COMMISSIONERS OF THE COUNTY OF LEHIGH,
PENNSYLVANIA, THAT:**

1. The above purpose clauses are incorporated herein by reference.

2. The proposed Right-of-Way Agreement, attached hereto is hereby approved, under the terms and subject to the conditions expressly set forth therein.

3. The proper officers and other personnel of Lehigh County are hereby authorized and empowered to execute the Right-of-Way Agreement and any other ancillary documents that serve the purpose of this Ordinance in final recordable form, if applicable, and take all such further action, including any necessary transfers of funds, as they may deem appropriate to carry out the purpose of this Ordinance.

4. The County Executive shall distribute copies of this Ordinance to the proper officers and other personnel of Lehigh County whose further action is required to achieve the purpose of this Ordinance.

5. Any Ordinance or part of any Ordinance conflicting with the provisions of this Ordinance is hereby repealed insofar as the same affects this Ordinance.

6. This Ordinance shall become effective in ten (10) days after enactment.

ADOPTED this ____ day of _____, 2013, by the

following vote:

Commissioners

AYE

NAY

Thomas C. Creighton, III
Percy H. Dougherty
David S. Jones, Sr.
Daniel K. McCarthy
Vic Mazziotti
Brad Osborne
Scott Ott
Lisa Scheller
Michael P. Schware

ATTEST: _____

Clerk to the Board of Commissioners

APPROVED this _____ day of _____, 2013.

MATTHEW T. CROSLIS
County Executive

ENACTED this _____ day of _____, 2013.

Prepared by: PPL Electric Utilities
Return to: PPL Electric Utilities
827 Hausman Road
Allentown, PA 18104
Attn: Alfred L. Birt
(484)634-3268

PIN: 547693801175 1

Form 4337 (2/2002)

W.O. Number:							
4	2	1	0	0	6	5	9



RIGHT-OF-WAY AGREEMENT
Corporation

KNOW ALL MEN BY THESE PRESENTS, That Lehigh County, a corporation of Pennsylvania hereinafter called "GRANTOR", intending to be legally bound, does hereby for itself and its successors and assigns grant unto PPL ELECTRIC UTILITIES CORPORATION, hereinafter referred to as "PPL", its successors, assigns and lessees, the right, privilege and authority to construct, reconstruct, operate and maintain its electric and communication lines consisting of one (1) pole, one (1) pad mounted transformer and underground facilities as shown on plan hereto attached and made a part hereof including, wires, cables, fixtures and apparatus upon, across, over, under and along the property which said Grantor owns or in which it has any interest located along Broadway Road, situate in the Township of South Whitehall, County of Lehigh, Commonwealth of Pennsylvania; and along the public highways adjoining the said property, including the right of ingress and egress to and from the said lines for any of the aforesaid purposes; also the right to cut down any and all trees within fifteen (15) feet each side of centerline of the electric/communication line and the right to trim any and all trees within fifteen (15) feet each side of centerline of the electric/communication line and to remove brush along said lines which in the judgment of said PPL menace the said lines; and also the right to permit the attachment of wires and cables of any other person or company to said poles. The said PPL, its successors and assigns shall not be limited in its or their enjoyment of the rights hereby granted as may be first constructed, but shall have at all times in the future the right to construct, operate and maintain and from time to time to reconstruct additional electric/communication wires, cables, fixtures and apparatus upon, across, over, under and along subject property. Any poles or facilities erected hereunder along a highway, whether within or outside the highway limits, may be relocated to conform to new or relocated highway limits.

A copy of this agreement and an acceptance hereof by PPL shall be filed by PPL with the Pennsylvania Public Utility Commission, and this agreement shall thereafter become effective in accordance with the provisions of the Public Utility Law.

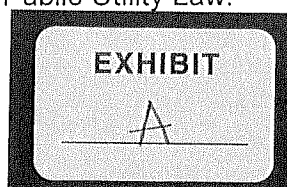

IN WITNESS WHEREOF, Grantor has caused this agreement to be executed in its corporate name by its proper officers, this _____ day of _____, 2013.

17 South 7th Street – Allentown, PA 18101-2400

P.O. Address

ATTEST:

County of Lehigh
By:

(SEAL

(SEAL)

Secretary

COMMONWEALTH OF PENNSYLVANIA)

: SS

COUNTY OF LEHIGH)

On this _____ day of _____, 2013 before me, the undersigned officer, personally appeared _____ who acknowledged himself to be the _____ (officer) of Lehigh County, a corporation and that he as such _____ (officer) is being authorized to do so, executed the foregoing instrument for the purposes therein contained by signing the name of the corporation by himself as _____(officer).

IN WITNESS WHEREOF, I have hereunto set my hand and notarial seal.

Notary Public

Do not write below this line

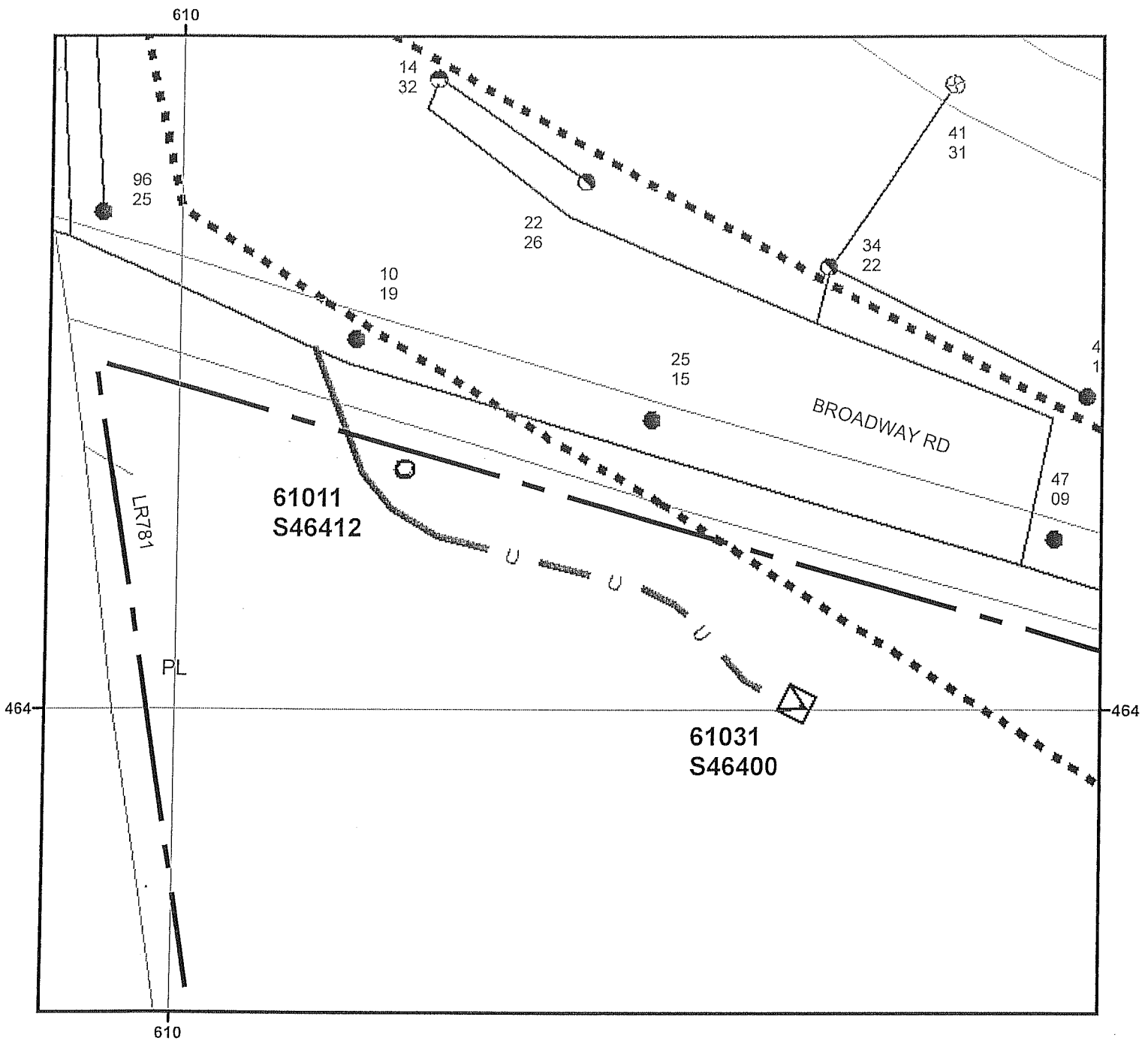

Legend

- ⊙ Foreign Owned Pole, Existing
- ⊗ Pole, Existing
- Pole, Proposed
- Pole, Existing
- ⊠ PM Transformer-3 Ph, Proposed
- Property Line, +/-
- Overhead Wires, Proposed
- Overhead Wires, Existing
- U Underground Cables, Proposed

Note:

For exact location of right-of-way and/or facilities within right-of-way, contact the local PPL Electric Utilities Corporation office.

Not for Construction

WO/Design: 42100659/26007	PLAN SHOWING FACILITIES ON PROPERTY OF:	
ER: 349120		
SR:		
SCALE: None	SOUTH WHITEHALL TWP LEHIGH COUNTY	
DATE: 9/18/2013	APPROVAL:	DATE:
ENGR: Hartrick, Scott R.	SIGNATURE:	
	DWG. NO.:	

